



A brAlight Future

Alex Poulis, Director, TransPerfect
Dataforce

Enrico Santus, Data Scientist,
Bayer/MIt



TRANSPERFECT
DATAFORCE



NLP – Uni Saarland
European Parliament
TransPerfect DataForce
Data Solutions for
products used by
Billions

WITH GREAT DATA COMES GREAT
RESPONSIBILITY

*CHANGING THE WORLD, ONE
PROJECT AT A TIME*



MIT

691 Citations

Adverse Event Detection

Precision Medicine

SDD at Bayer

December 11, 2040

Dr. Monique Weber

7.34 hours of sleep



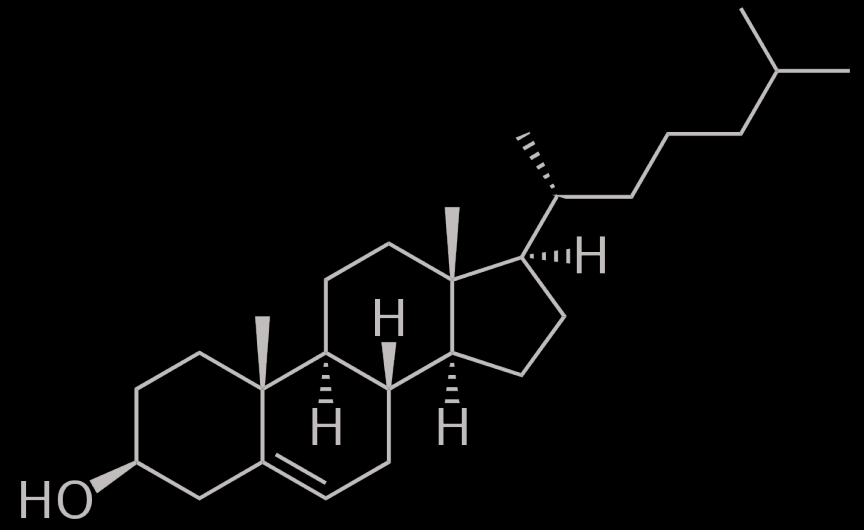







DOLOR SIT AMET

- DOLOR** UT ENIM AD MINIM VENIAM PROSTIBUS EXERCITATION UNA **325486**
- MAGNA** UT ENIM AD MINIM VENIAM PROSTIBUS EXERCITATION UNA **521463**
- LOREM** LABORIS ALIQUIP EX EA COMMODO CONSEQUAT FAUTE **235849**
- IPSUM** IRURE DOLOR IN UT REPREHENDIT IN VOLUPTATE VELIT ES **475127**



CONSECTETUR

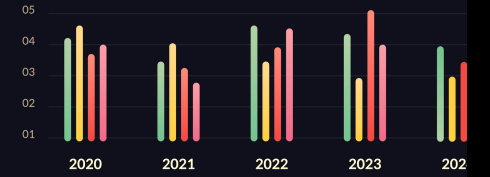

DUIS AUTE

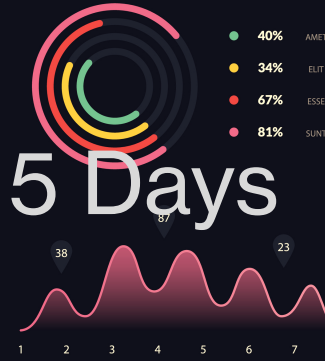

IPSUM DOLOR



LOREM IPSUM

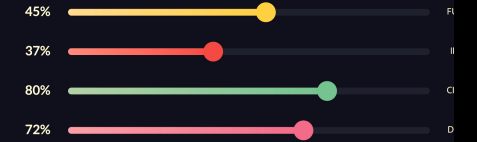

- LOREM** UT ENIM AD MINIM VENIAM PROSTIBUS EXERCITATION UNA
- IPSUM** LABORIS ALIQUIP EX EA COMMODO CONSEQUAT FAUTE
- DOLOR** UT ENIM AD MINIM VENIAM PROSTIBUS EXERCITATION UNA
- MAGNA** IRURE DOLOR IN UT REPREHENDIT IN VOLUPTATE VELIT ES

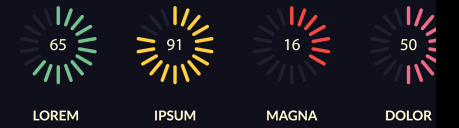

100%







Forecast 2041

Meanwhile in 2020...

Predict the Future



Tesla
Apple



Facebook
Amazon
Google
Waze

e-Translation



Artificial Intelligence for Healthcare in 2020

The US spends more on healthcare than any other country

Percent of GDP*

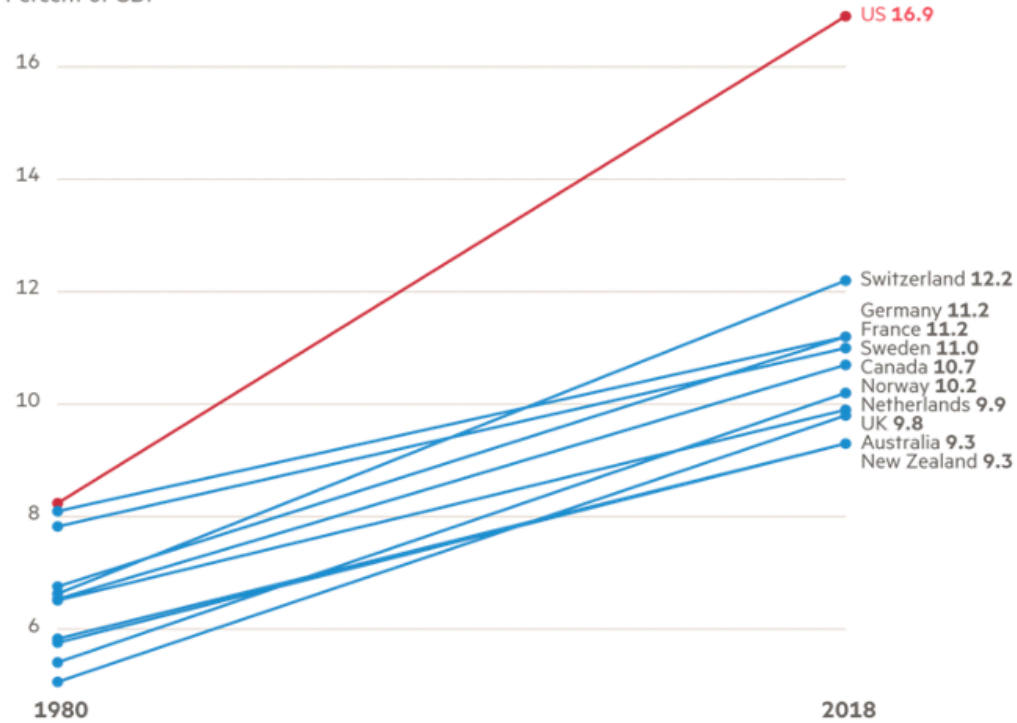

Source: OECD
© FT

* Adjusted for differences in cost of living

Big Spender: global health spending per capita

Adjusted for differences in cost of living, 2019 (\$)

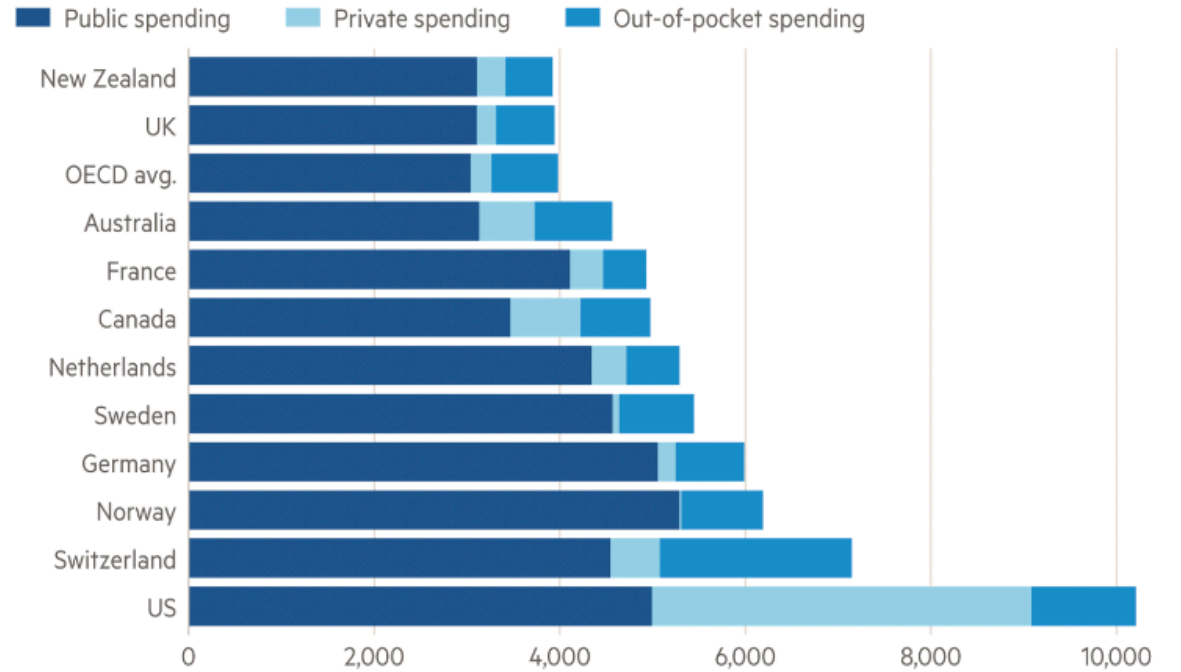

Source: OECD
© FT



Data has
Better idea

183.102

154.178

245.5

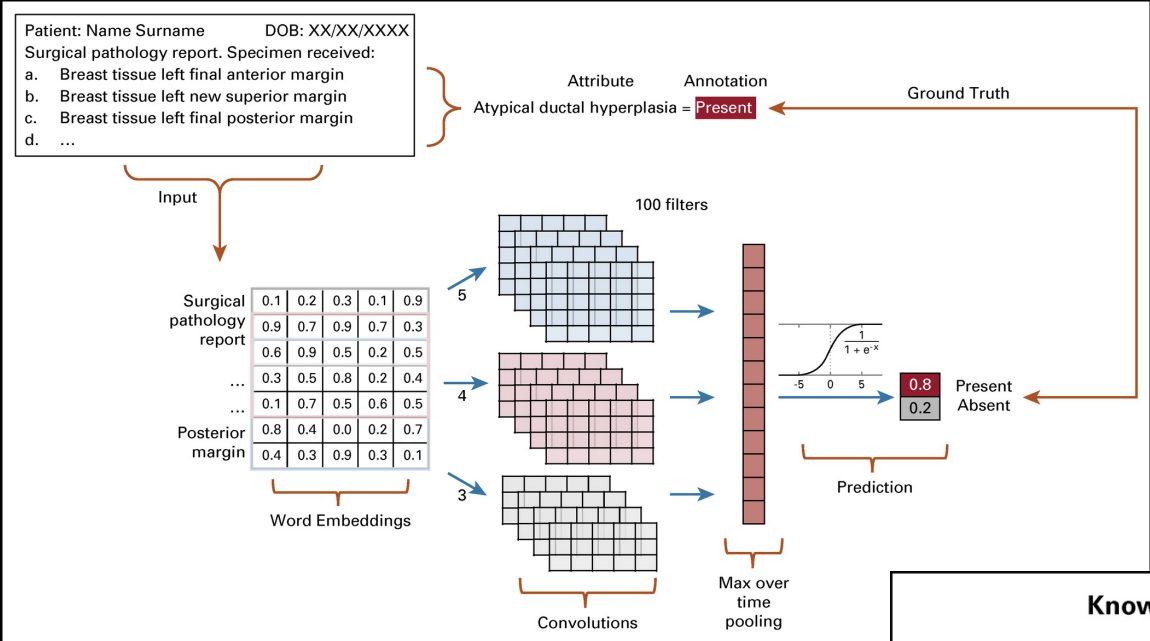

3.2% improvement with same amount of data

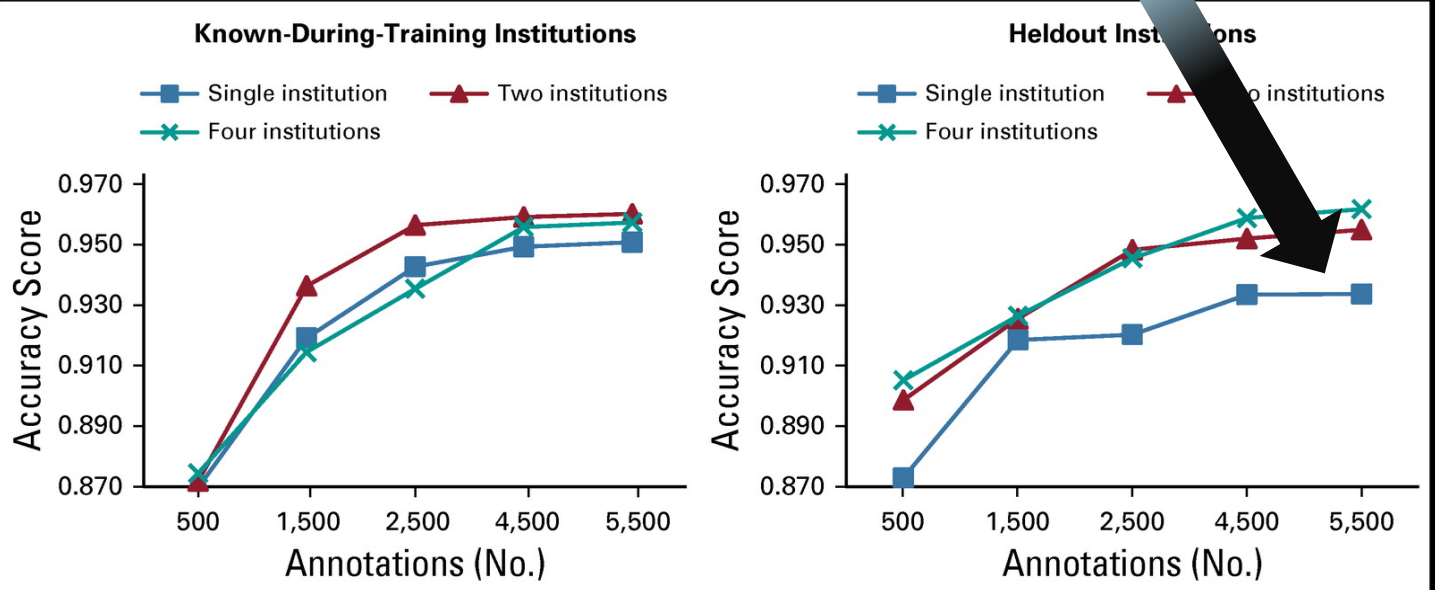

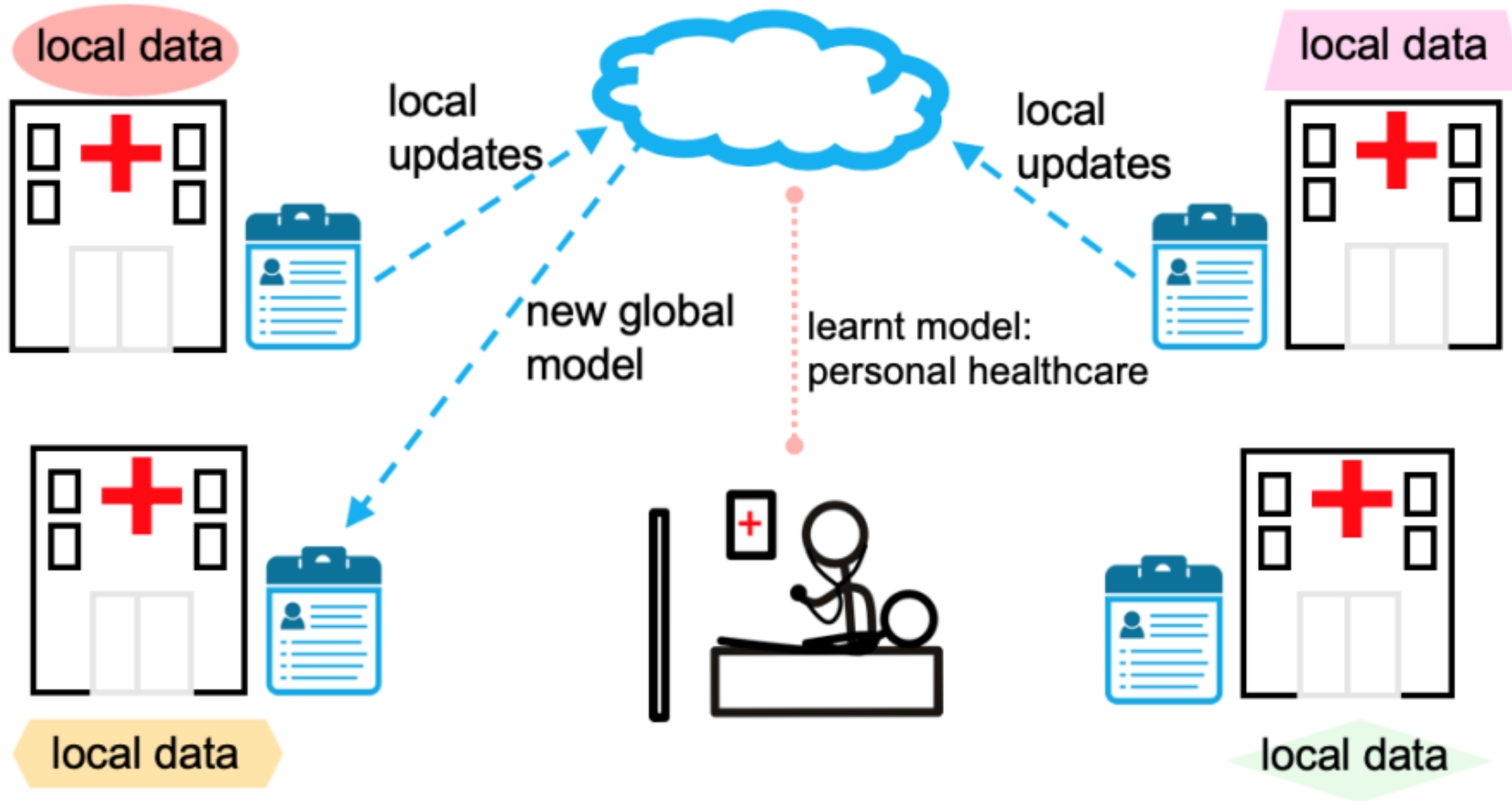

Injecting knowledge through dictionaries and rules

Transfer Learning

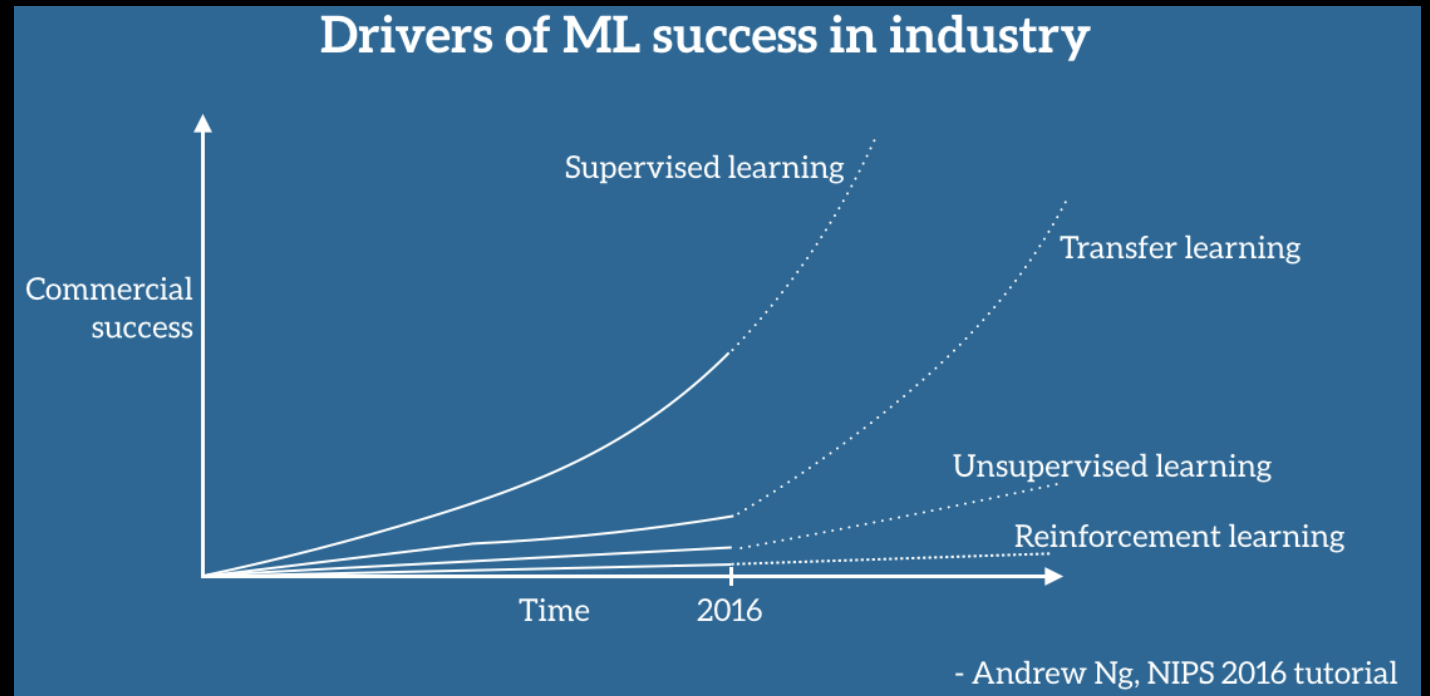

According to Andrew Ng, Transfer Learning is going to lead the next wave of commercial ML.

Data Labelling: We can't stand
it and we can't live without it...

Real World Applications

and if they are based on the current prospectus and the Key Investor Information Document (KIID) as well as the most recent semi-annual report if published after the most recent annual report. No information shall be included in the prospectus, the KIID or in any other document referred to in the prospectus which is not contained in the prospectus, the KIID or in any other document referred to in the prospectus. Shares in UBAM (hereafter "UBAM" or the "SICAV") may not be acquired or held, directly or indirectly, by investors who are not authorized for the transfer of the SICAV's shares to such investors authorized. For the purposes of this Prospectus, the definition of "U.S. Person" in Rule 902(k) of Regulation S promulgated under the US Securities Act of 1933 (as amended), "United States" means: The United States of America, its territories and possessions, any State or the District of Columbia, and any political subdivision thereof; "U.S. Person" means: 1. any natural person who is a citizen of the United States (including dual citizens); 2. any natural person who is domiciled in the United States; 3. any partnership or corporation organized or incorporated under the laws of the United States; 4. any partnership or corporation whose principal office is in the United States; 5. any partnership or corporation whose executor or administrator is a U.S. Person or the income of which is subject to US income tax regardless of source; 6. any agency or instrumentality of the United States; 7. any non-discretionary account or similar account (other than an estate or trust) held by a U.S. Person; 8. any discretionary account or similar account (other than an estate or trust) held by a U.S. Person.

Investment Banking

Data Relevance

Additional comments

Labels 1 NAV (Net Asset Value) 2 Dividend distribution 3 Settlement date 4 Accounting currency 5 Organization 6 Person 7 Country

UBP_logo_new [Converti] sans geProspectus **UBAM Variable Capital Investment Company** **Luxembourg** JULY 2019NUR FÜR ANLEGER IN **ÖSTERREICH** Subscriptions are only valid if they are based on the current prospectus and the Key Investor Information Document (KIID), accompanied by the most recent annual report, as well as the most recent semi-annual report if published after the most recent annual report. No information may be provided by any party on the investment company which is not contained in the prospectus, the KIID or in any other document referred to in the prospectus and which is available to the public. Shares in UBAM (hereafter "UBAM" or the "SICAV") may not be acquired or held, directly or indirectly, by **U.S.** Persons as defined below; neither is the transfer of the SICAV's shares to such investors authorised. For the purposes of this Prospectus (but subject to applicable law, including Rule 902(k) of Regulation S promulgated under the US Securities Act 1933, as amended), Definition of **United States of America** and U.S. Person A) "United States" means: The United States of America, its territories and possessions, any State of the United States, and the District of Columbia. B) "U.S. Person" means: 1. any natural person who is a citizen of the United States (including dual citizens and U.S. born); 2. any natural person resident of or in the **United States**; 3. any partnership or corporation organized or incorporated under the laws of the United States; 4. any estate of which any executor or administrator is a U.S. Person or the income of which is subject to US income tax regardless of source; 5. any trust of which any trustee is a U.S. Person or the income of which is subject to US income tax regardless of source; 6. any agency or branch of a foreign entity located in the United States; 7. any non-discretionary account or similar account (other than an estate or trust) held by a

Waste Management

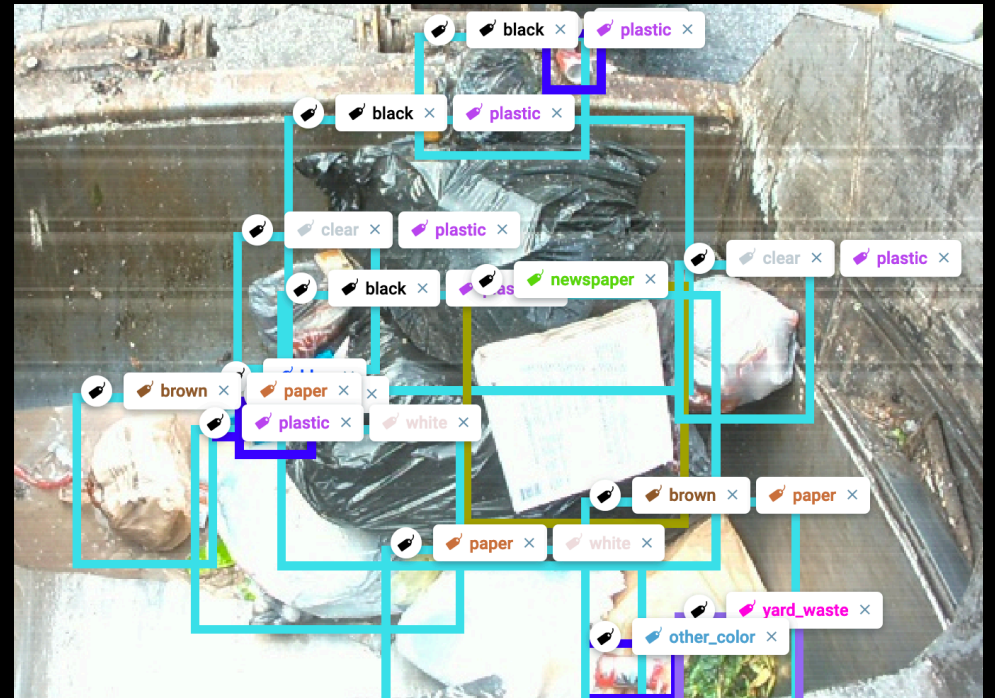



2013
 2013 1m
 2013 1m Sm
 2017
 2017 1m
 2017 1m Sm
 Proj
 Change
 Change
 Path

Monitoring of Natural Resources

P 2013
 2013 Change
 2017 Change
 P 2017
 End NLCD 2013
 End NLCD 2013 1m
 End NLCD 2013 1m Smoothed
 End NLCD 2017
 End NLCD 2017 1m
 End NLCD 2017 1m Smoothed
 End NLCD Proj
 End 2013 Change
 End 2017 Change
 2013 Land Use
 2017 Land Use
 2013 NLCD
 2017 NLCD
 2013 NLCD Change
 2017 NLCD Change



Insurance

ACME Acme, Inc.
555-555-1234 x137

Invoice Number #000010
Issue Date 2018-04-10
Due Date 2018-04-10

Bill to: Marty McFly
200 Billing Rd.
Suite 100
Needham, MA 02494

Ship to: Marty McFly
100 Shipping St.
Apt 200
Pleasantville, NC 12345

PAID \$2,781.00

> Subscription 1: Professional Plan Cloud Compute Servers	Total	\$515.25
> Subscription 2: Professional Plan Cloud Database Service	Total	\$1,532.25
> Subscription 3: Standard Plan Cloud File Storage	Total	\$733.50

Subtotal \$3,090.00
Total Discounts (\$309.00)
Grand Total \$2,781.00

Paid \$2,781.00
Due \$0.00

Payment History
04/10/2018 01:35PM EDT Credit card payment: \$2,781.00 (Visa, XXXX-XXXX-XXXX-1111)

Invoice Number	0000010	Issue Date	2018-04-10	Due Date	2018-04-10
Paid #	\$2,781.00				
Bill To	Marty McFly	Ship To	Marty McFly		
Billing Address	200 Billing Rd. Suite 100	Shipping Address	100 Shipping St., Apt 200		
Billing Address 2	Needham, MA 02494	Shipping Address 2	Pleasantville, NC 12345		
Concept	Subscription 1: Professional Plan		Total	\$1,522.25	



Healthcare

Our case is the second one in which hemorrhage from a meningioma may have been induced by aspirin prophylaxis. On the other hand, aspirin may have promoted the enlargement of spontaneous hemorrhage from meningioma. Furthermore, inadequate control of hypertension may have been another cause of hemorrhage.

Labels

1 Pharmacological substance

2 Disorder

Our case is the second one in which **hemorrhage** from a **meningioma** may have been induced by **aspirin** prophylaxis. On the other hand, **aspirin** may have promoted the enlargement of **spontaneous hemorrhage** from **meningioma**. Furthermore, inadequate control of **hypertension** may have been another cause of **hemorrhage**.

Scalability

POC with 1,000 files
Product: 500,000 files

Data Privacy

Health data
PII
Financial information

Real World Data

Does my model work on them?

Budget-Timeline-Quality

Specialization

Languages

Human-in-the-Loop

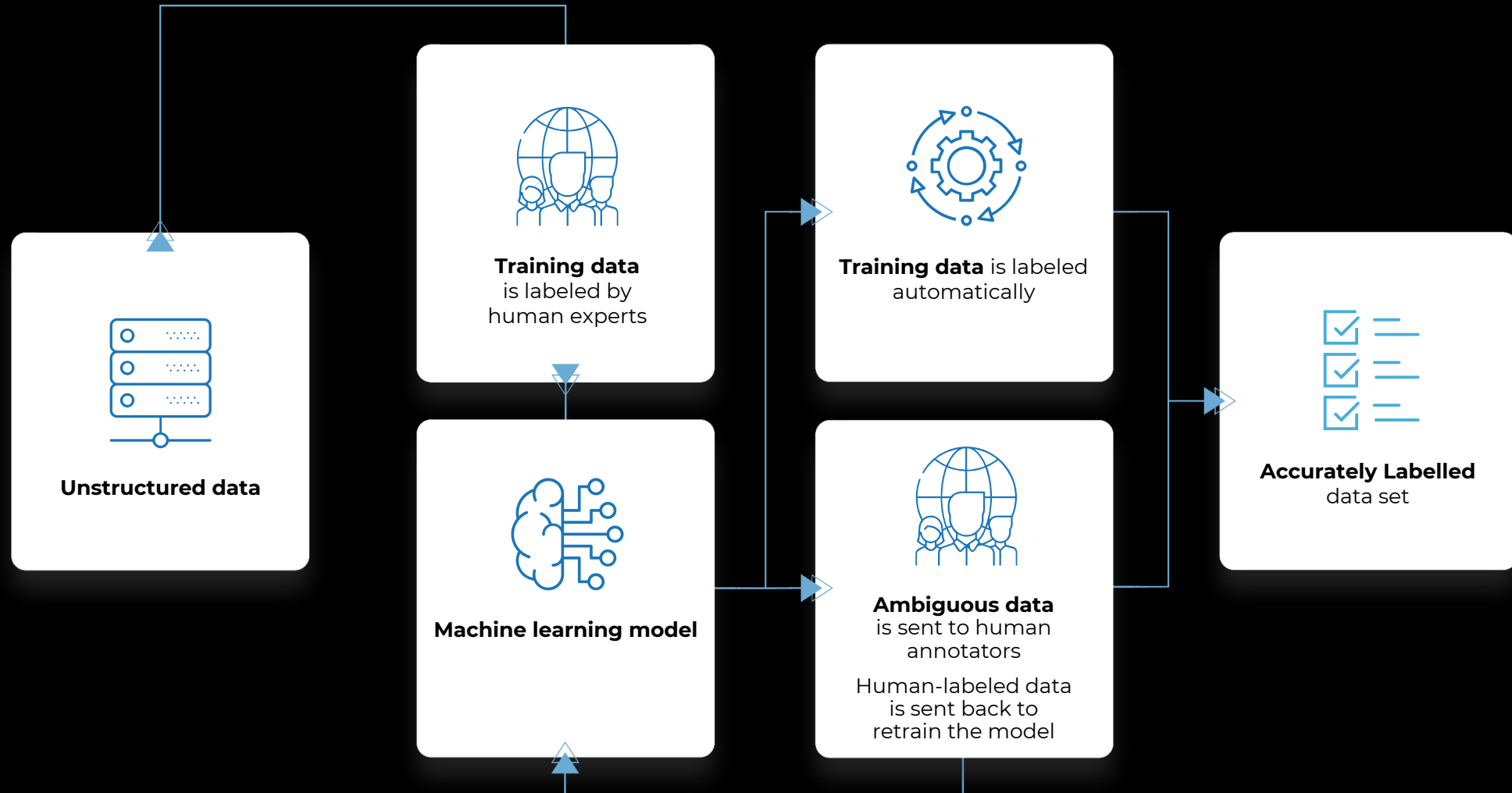

How?

Spreadsheets and Word processors



Expensive and Error Prone

Develop specialized tools



Expensive and Time Consuming

Crowd-sourcing



Unpredictable quality. Limited language coverage. Simple tasks only

Managed Data Services



High quality, Domain Expertise, Language coverage, Client Services

Managed Data Services

Scale



1M+ annotators

Flexibility



Customizable tools for NER, CV, OCR, Speech, Search

Efficiency



Automated workflows for PII redaction and work allocation

Security and Privacy



Compliance with various security and privacy protocols including GDPR, HIPAA, SOC2, ISO 27001 and others

Domain Expertise



Finance, Legal, Medical etc.

Accountability



Contractual frameworks and industry-level metrics

Healthy Population
Inclusion and education for all
Sustainable mobility
Environment
Sustainable finances



THANK YOU